

XJ600e

Technical manuals, drawings & component photos

battery management chassis

Zeva Precharger 50ohm (12-180VDC)

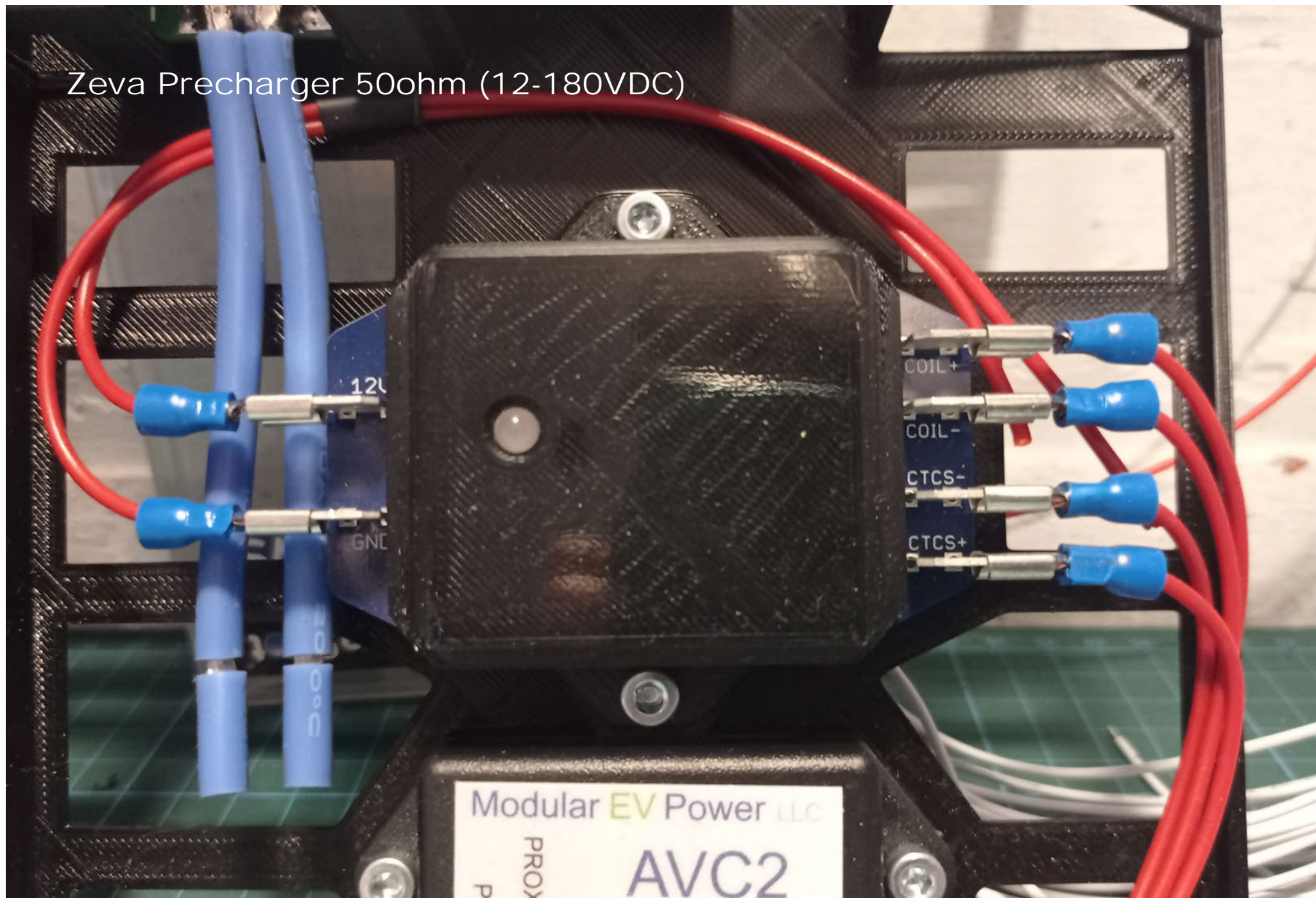

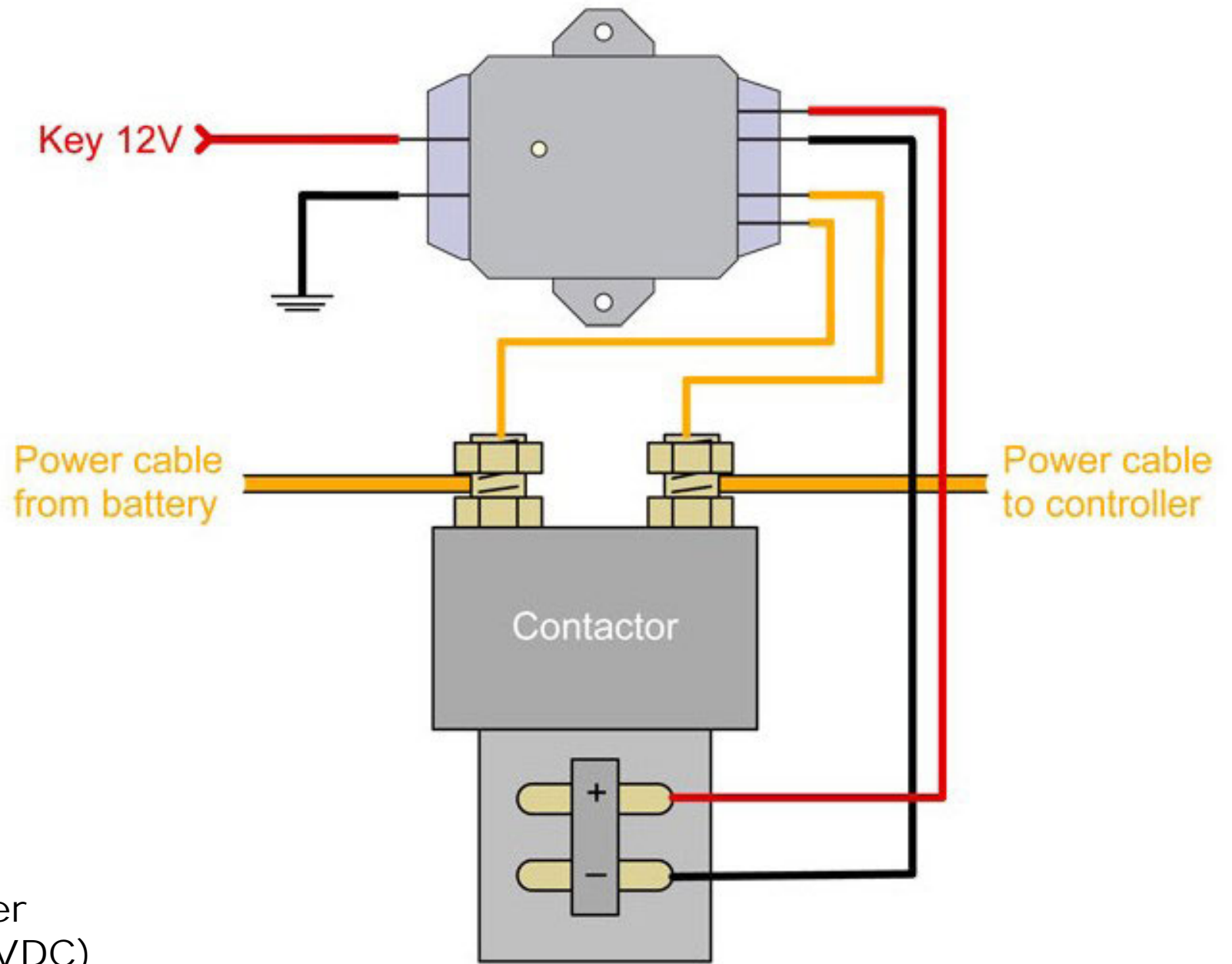

Zeva Precharger
50ohm (12-180VDC)

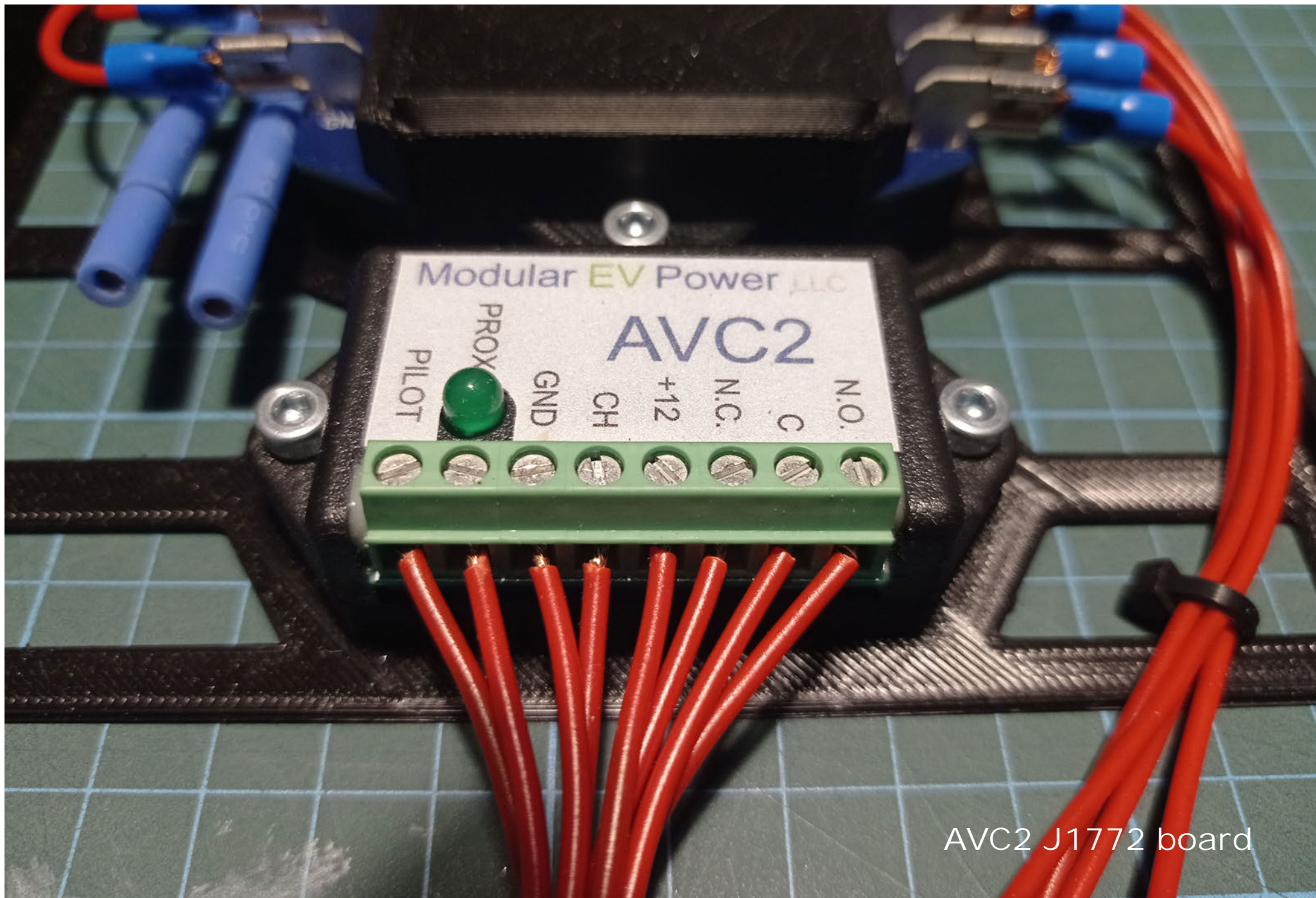

AVC2 J1772 board

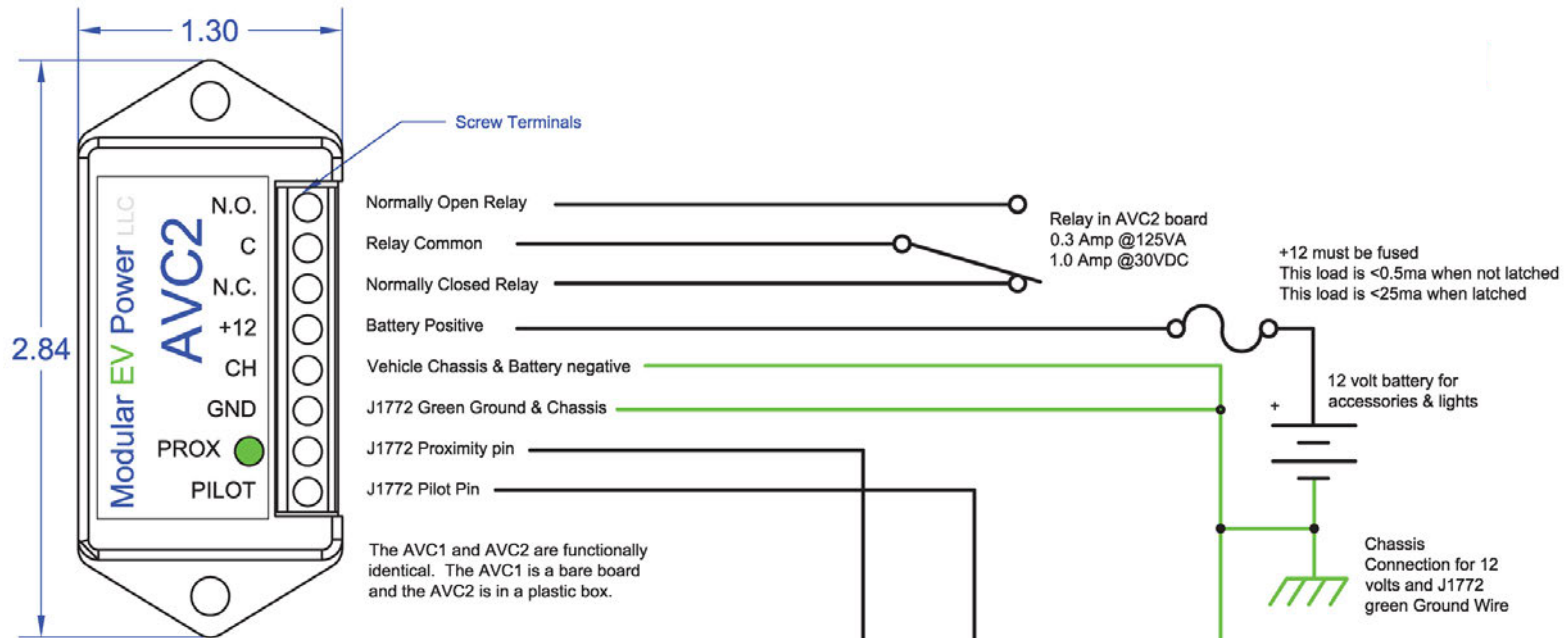

Operation:

Apply +12 volt DC power. The unit may have switched power that enables the charge process or it may be left on continually. The power can come from any fused source.

Initially with the J1772 not mated the relay will be off and the NC (normally closed) contact will be connected to the relay common.

When the J1772 Cable is plugged into the inlet the pilot signal is changed immediately to connected. Still no power is available for charging while the connector is being mated.

Then the latch on the J1772 connector locks on the inlet, after the trigger is released the AVC1 board will use the proximity signal and activate the relay connecting common to Normally Open. The green PROX LED (proximity or latch) will indicate this. The pilot signal will also be changed to request power from the EVSE.

Later when it is time to disconnect, pressing the trigger to release the connector latch is sensed by the AVC1 board. The relay turns off, the connection returns to common to Normally closed, the green PROX LED goes off, and the pilot signal is changed back to CONNECTED and stops charging power. This all happens before the connectors are separated.

Signal	ITT J1772	Aluminum	Chinese
Ground	Green	Green	Yellow/Green
AC Power	Red	Red	Red L large
AC Power	Black	Black	Black N large
Pilot	Orange	Blue	Red CC small
Proximity	Blue	Violet	Black CP small

Normal orientation of Inlet connector with latch on top.

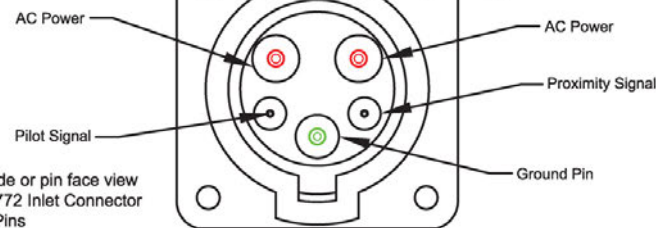

AVC2 J1772 board

Manual in link: <https://drive.google.com/file/d/1E0HEes6kgBze5DI5MRO2mkE8BmNdzXas/view?usp=sharing>

←B-接电池组的总负极

生产日期:
2020年 03月

双层小板



蚂蚁兴能®

三元锂支持10-24串任意串数
磷酸铁锂支持13-24串任意串数
钛酸锂支持15-24串任意串数

蚂蚁保护板BMS同口
10-24串200A 电流

支持苹果、安卓手机连接蓝牙一键点击设置磷酸铁锂、钛酸锂参数、默认为三元锂24串参数
连接蓝牙在参数设置内修改电池实际串数，查看默认为三元锂参数，修改成铁锂即可变更为铁锂参数保护参数
电池单体电压串联起来最高支持24串，（总电压范围36V-102V内）单串电压范围2V-4.5V

C-接负载和充电器的负极→

ANT BMS 200AMP

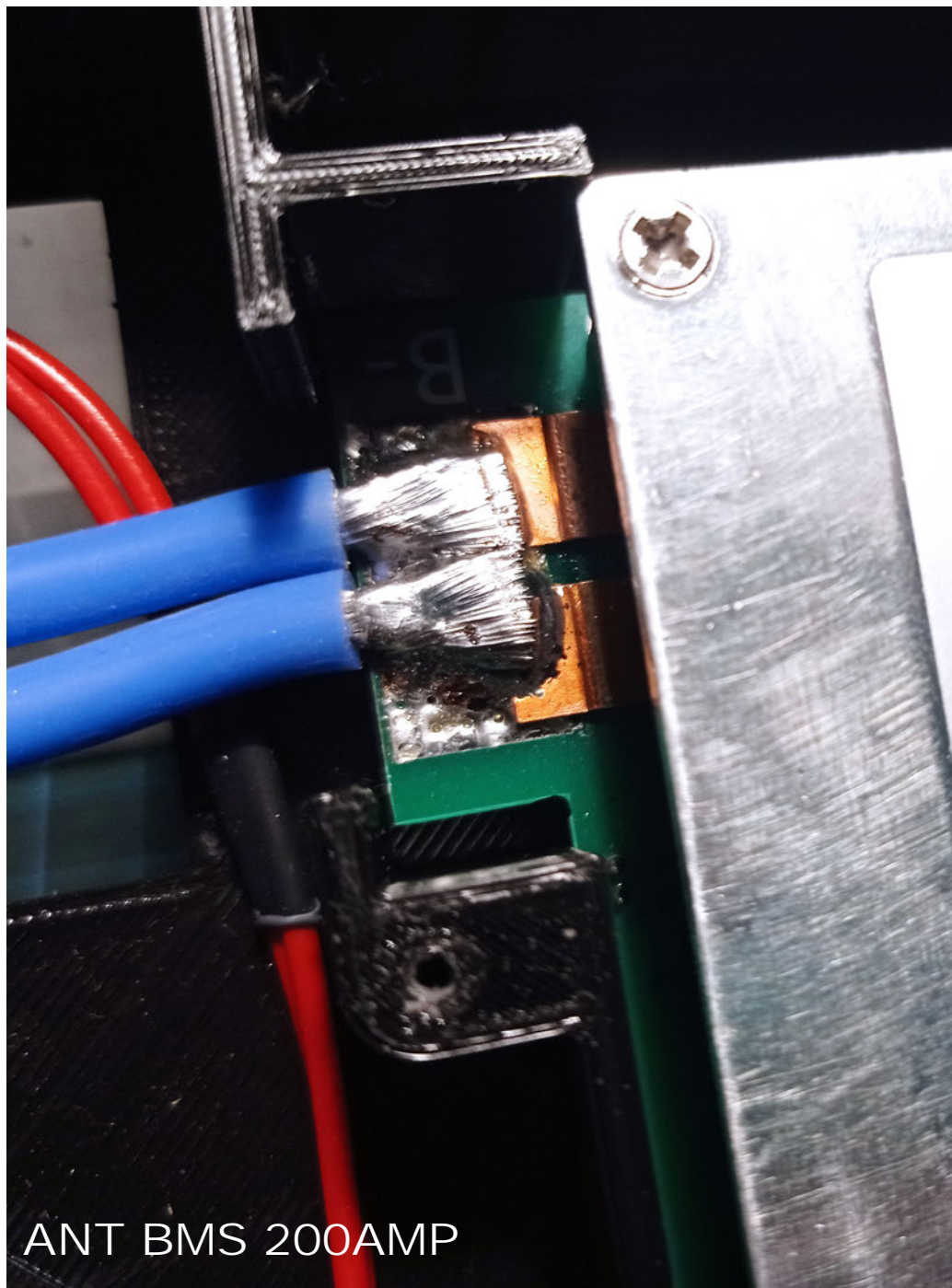

ANT BMS 200AMP

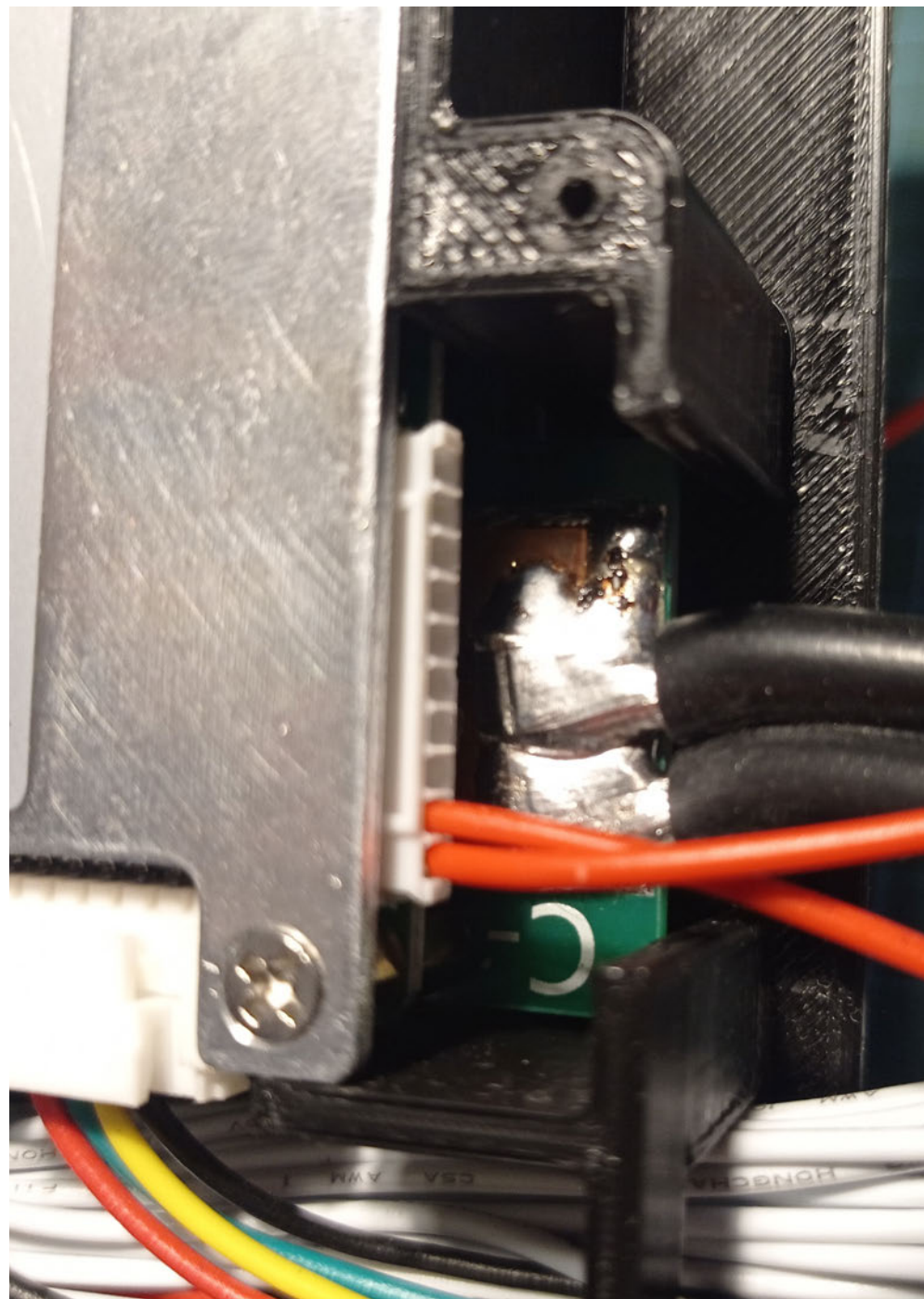

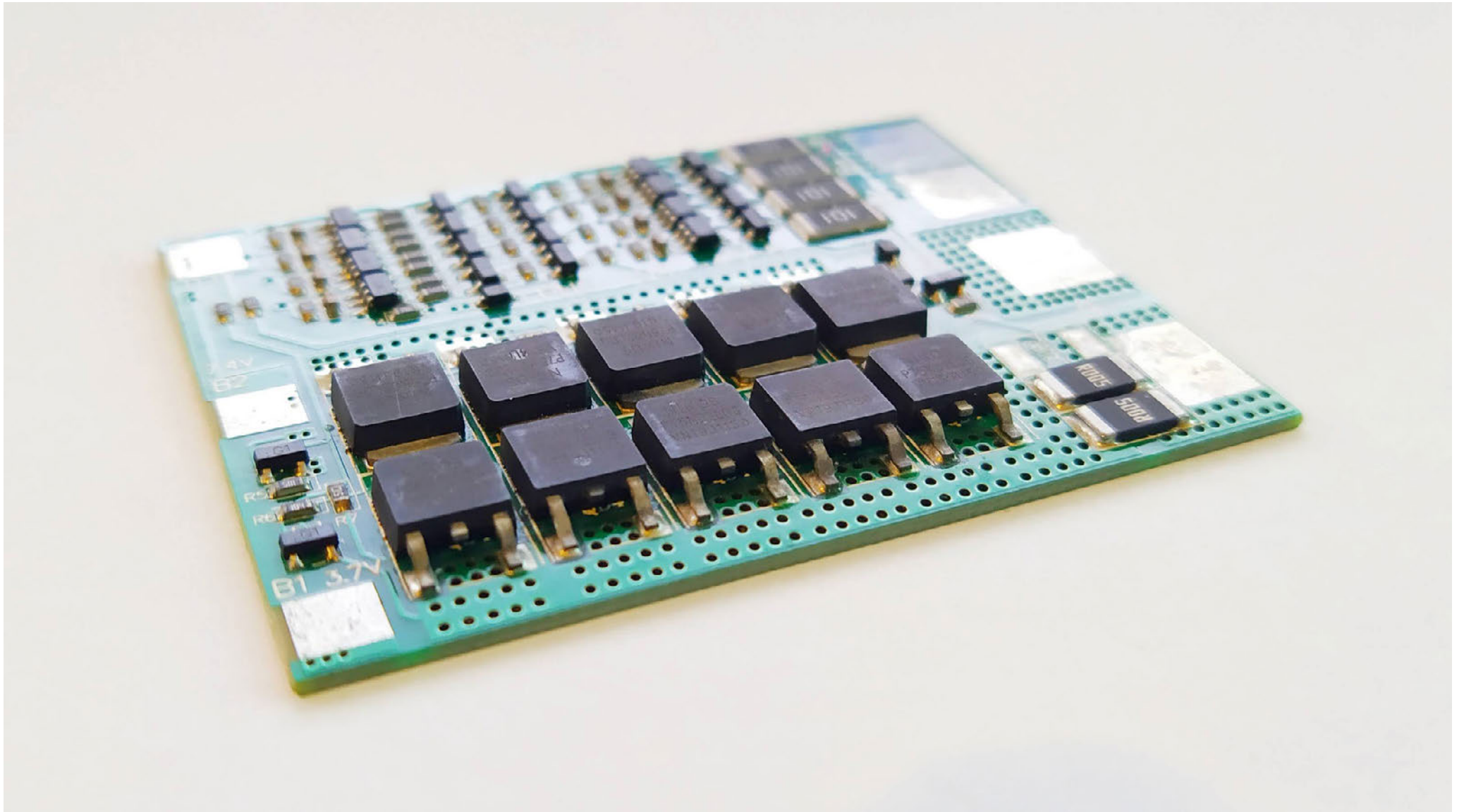

12V 30AMP BMS

3.7V Li-ion lithium 18650 Battery
BMS Protection Board
4S(4-Cell 14.8v 16.8v)
W/ Balance

30A

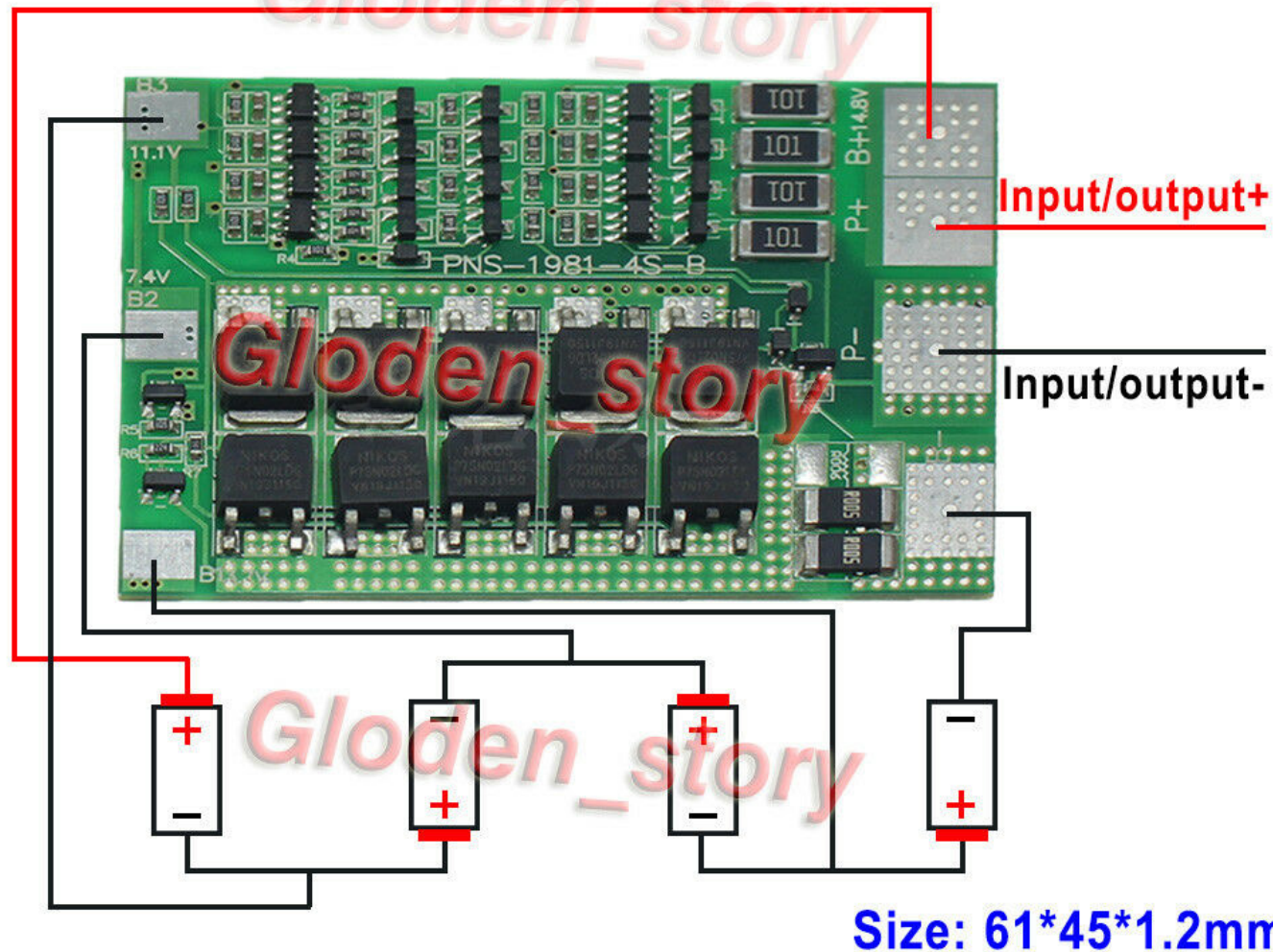

12V 30AMP BMS

Manual 1 in link: - <http://www.siaecosys.com/upfile/201908/2019081354118841.pdf>

Manual 2 in link: - <https://xj600e.files.wordpress.com/2019/06/qsmotor-after-sales-manuals-for-motor-kits-one-for-one-v2.3.pdf>

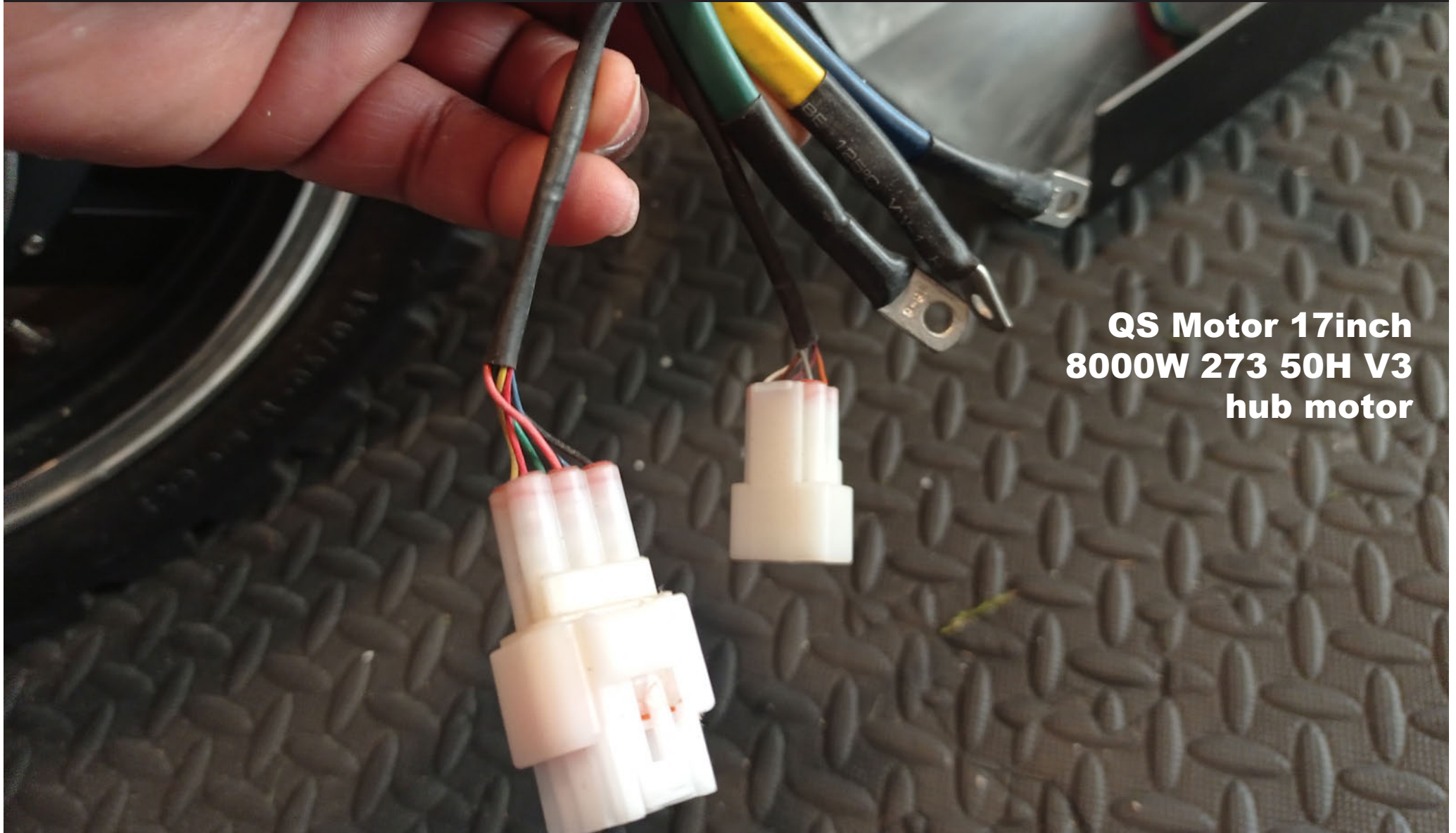

**QS Motor 17inch
8000W 273 50H V3
hub motor**



9v-30v headlight



H4 To H13 Adapter

9v-30v headlight

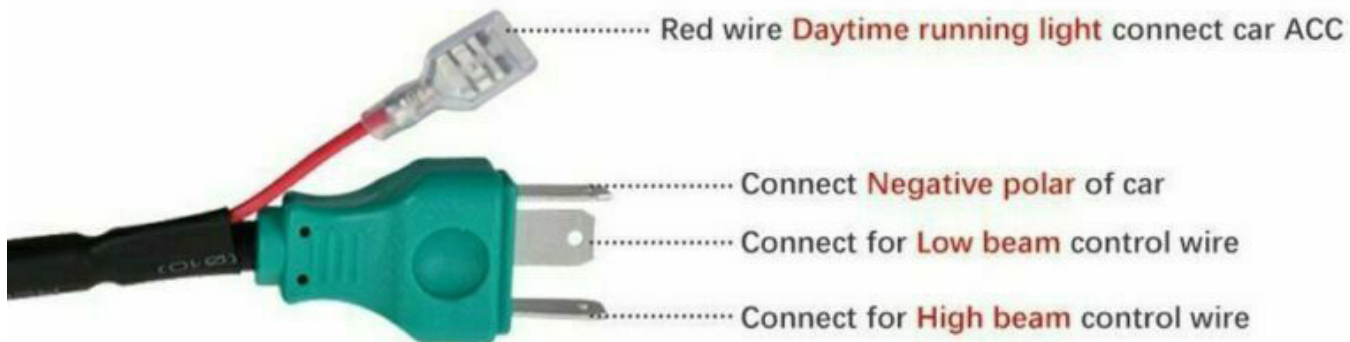

Manual link: <https://xj600e.files.wordpress.com/2021/06/ct-22-dashboard-manual.pdf>

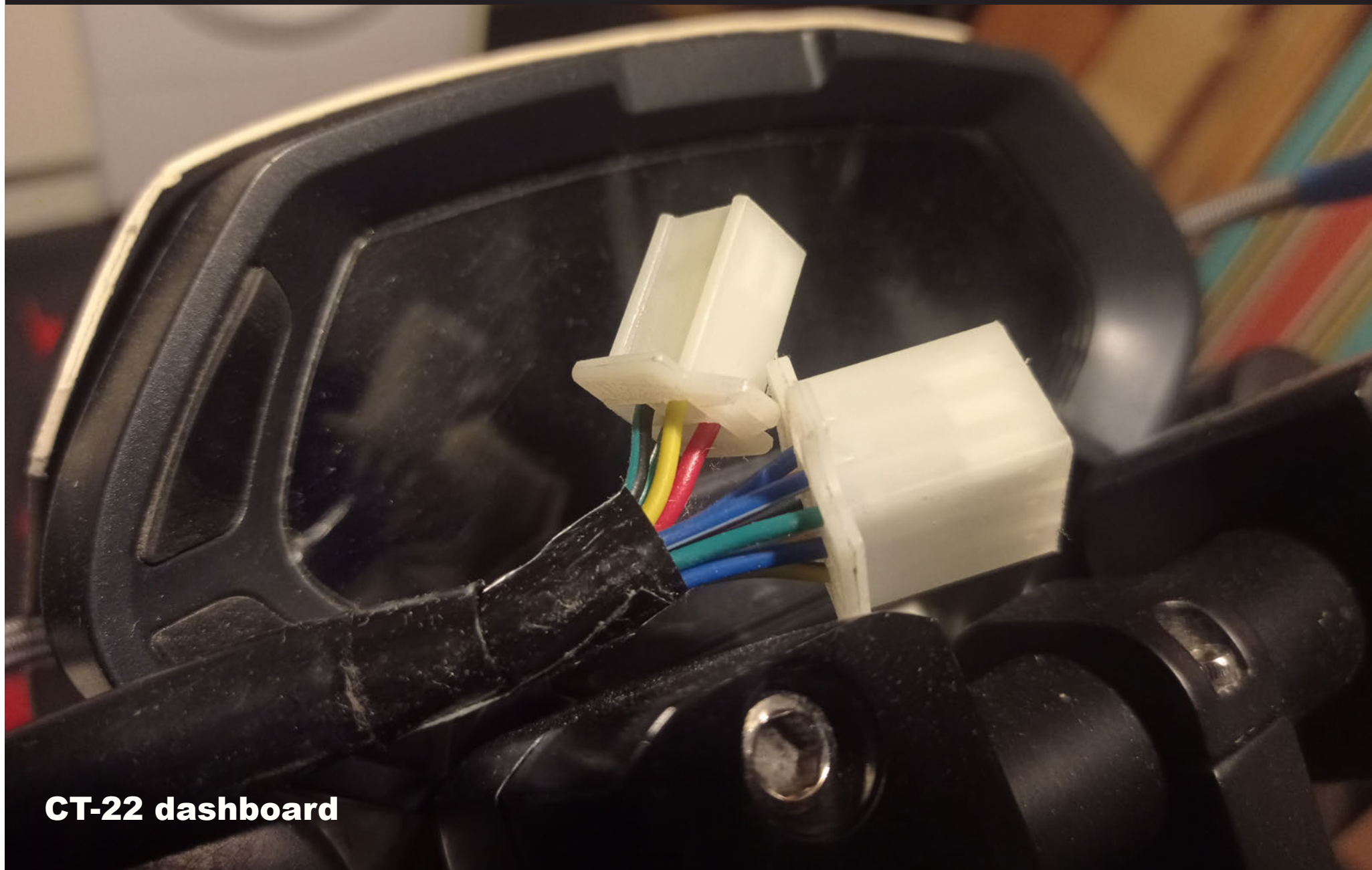

CT-22 dashboard

CT-22 Diagram (page 1)

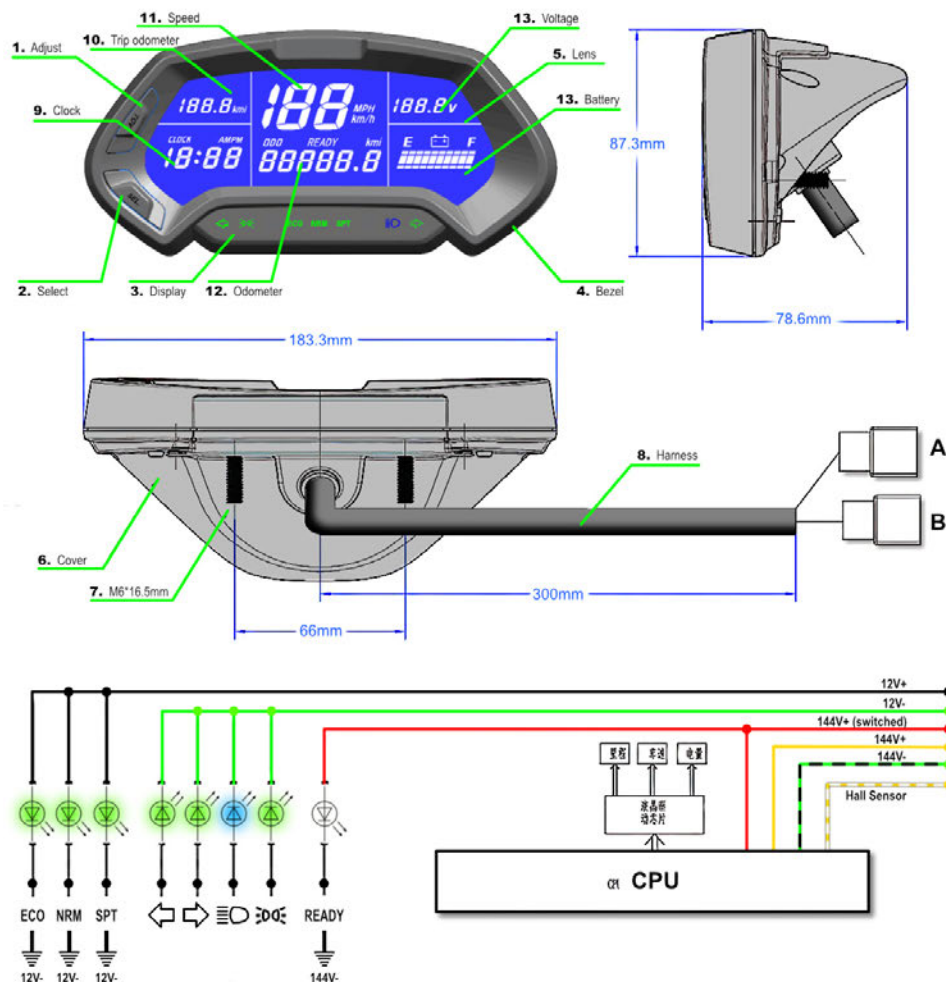

CT-22 dashboard

CT-22 Diagram (page 2)

Connector	No.	Display	Wire Color	function	display mode	Remark
B DJ7091A-2 8-21	1	Voltage/ Battery	Yellow	Full-time Power	White (Numeric)	Memory line for Speedometer functions (connect with battery DC+144V)
	2		Red	Switched Power		+144V, through electric lock
	3	144v ground	Green-Black	Ground for above		Connect with negative pole of 144v battery
	4	NA	Green	LED 12V- Ground	NA	Connect with negative pole of 12v convertor

	READY		System Ready	White (Text)	when speed is zero, LED light flicker and vice versa
--	-------	--	--------------	-----------------	--

A DJ7041A-2 8-21	5	NA	Black	LED 12V+ Power	NA	Connect with +12V of convertor,
	6	⊗	Blue/Red	Position Light	LED green	Connected with +12V, the lamp should light.
	7	⊙	Blue	High Beam	LED blue	Connected with +12V, the lamp should light.
	8	↗	Light Blue	Right turn signal	LED green	Connected with +12V, the lamp should light.
	9	↖	Orange	Left turn signal	LED green	Connected with +12V, the lamp should light.
	10	Speedometer	Yellow-White	Speed Signal	White (Numeric)	Connected with any one of three Hall signal wires from motor/controller.
	11	ECO	Blue-Green	Economy Mode	LED green	Connected with 12V ground, the lamp should light.
	12	NRM	Yellow-Black	Normal Mode	LED green	Connected with 12V ground, the lamp should light.
	13	SPT	Blue-White	Sport Mode	LED green	Connected with 12V ground, the lamp should light.

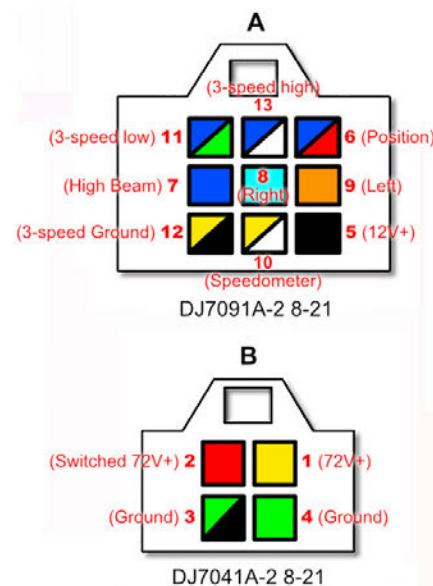

Technical Specifications

1. Working power supply is 144VDC, the indicator light source is 12VDC.
 The speed sensor signal is external digital (hall) signal

2. The speedometer technical specifications are as follows:

Intrinsic Error km/h	Signal Freq	140Hz	280Hz	420Hz	560Hz	700Hz	840Hz	980Hz	1120Hz	1260Hz
Value		20-21	40-42	60-63	80-84	100-105	120-126	140-147	160-168	180-190

3. The following table shows the relationship between power consumption and supply voltage:

Voltage level	<132V	132-134.5V	134.5-137V	137-139.5V	139.5-142V	142-144V	144-146V	146-148V	148-150V	>152V
1 flashing	2	3	4	5	6	7	8	9	10	

When running the display level only lowers, never rises. If it should fail, the waiting time is 30 s.
 The speed decrease for each block is 15 s. Power up again, select the table to display the number of levels.

4. Wire connectors should be equal to QJHTR-2007 (Jintai motorcycle cable harness technical spec)

5. 插接件及端子应符合QC/T417.1、QC/T417.2、QC/T417.3、QC/T417.4、QC/T417.5车用电缆束接插器之要求；

6. 导线应符合JB/T 8139《公路车辆用电缆（电线）要求》，导线截面积为0.5mm²；

7. 其余未注尺寸按三棱模型；

8. 未注尺寸公差按GB/T1804-v；

9. 组合仪表各项性能指标应满足QC/T727《汽车、摩托车用组合仪表》中的技术要求；

10. 仪表面板、衬板、底壳材料分别为透明PC、ABS、ABS；

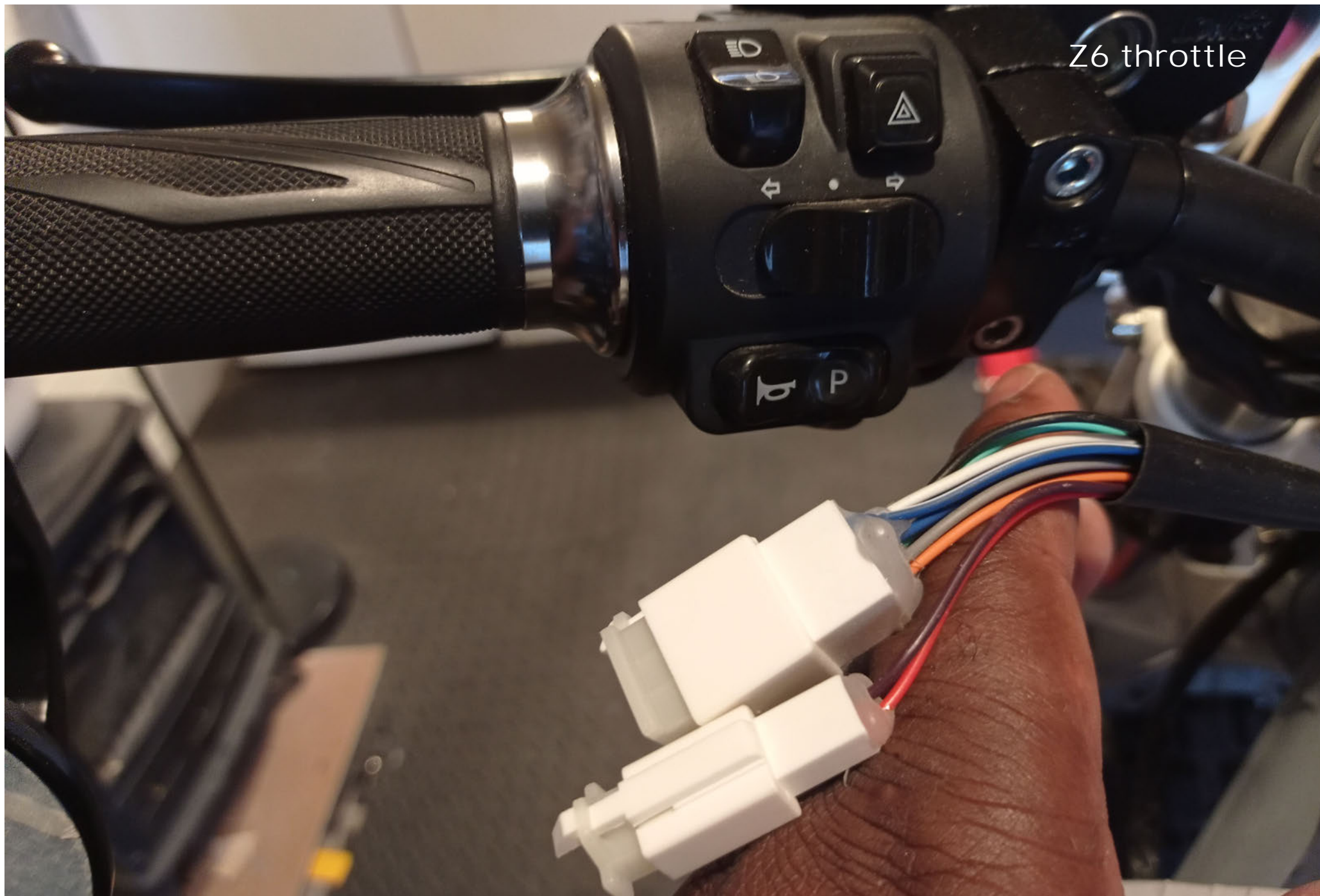

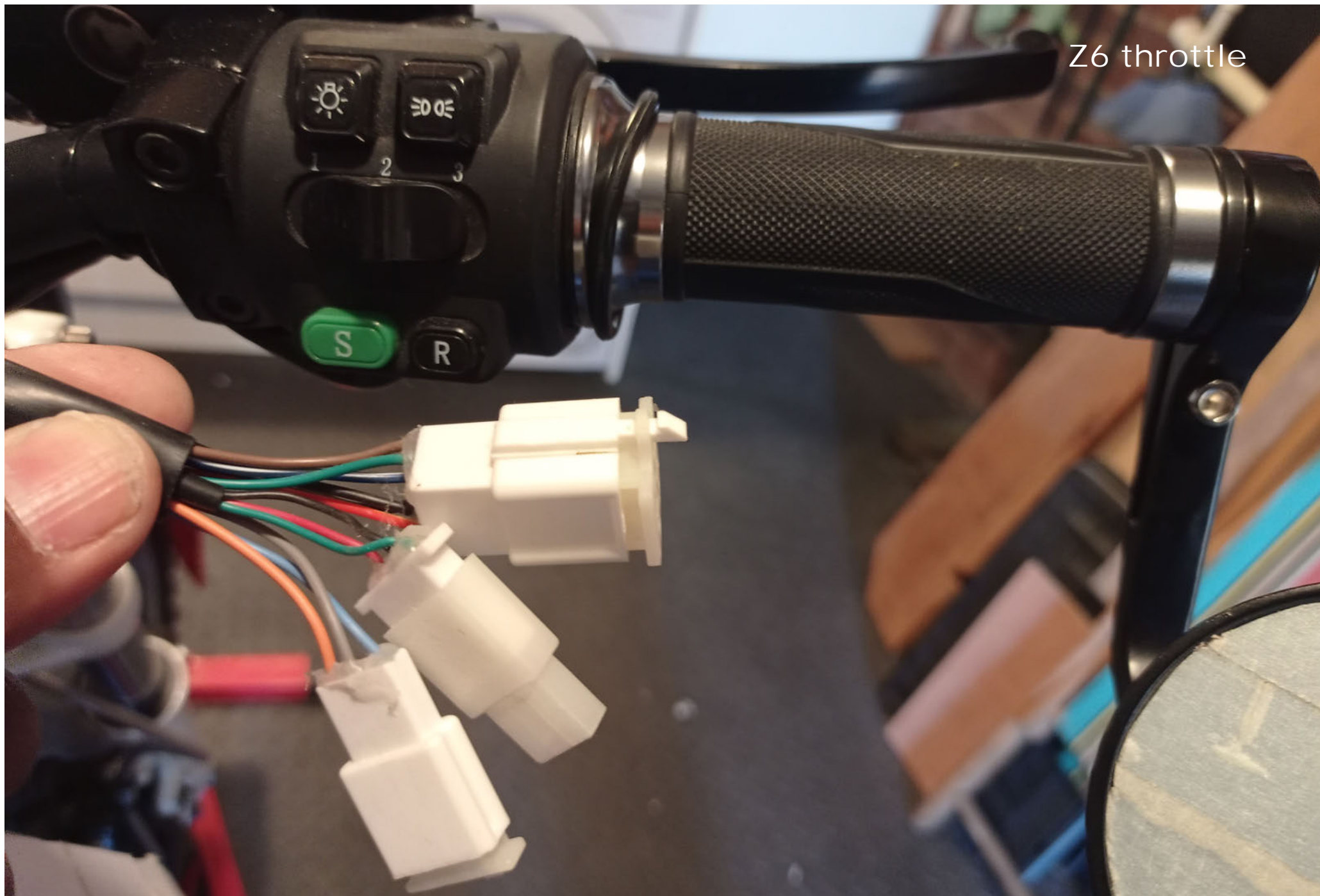

Z6 throttle

Z6 throttle

Multifunctional throttle Z6 with combination switches.

Basic parameters:

Color:	black
Rated operating voltage:	+5Vdc
Output voltage:	0.8 ~ 4.2Vdc
Current:	DC 10mA
Main material:	ABS PVC
Inner diameter of throttle:	22 mm
Waterproof rating:	IPX6
Net weight:	0.31kg
Right throttle pull force/ left handle pull force:	≥200N / ≥200N
Torsional strength:	≥9N.m
Service life:	≥100,000 times

Pin Out Explanation:

		 Speed throttle connector Signal / GNG / + 5Vdc
	S / R switch	 Three-speed switch connector Light blue / Grey / Orange
	Small light switch	 Three-speed switch explanation Light blue / Grey / Orange
	Big light Switch	
		
	Change-over switch	 P switch Purple / Red
	Dimmer switch	 Horn & P switch Light Green / Black / Purple / Red

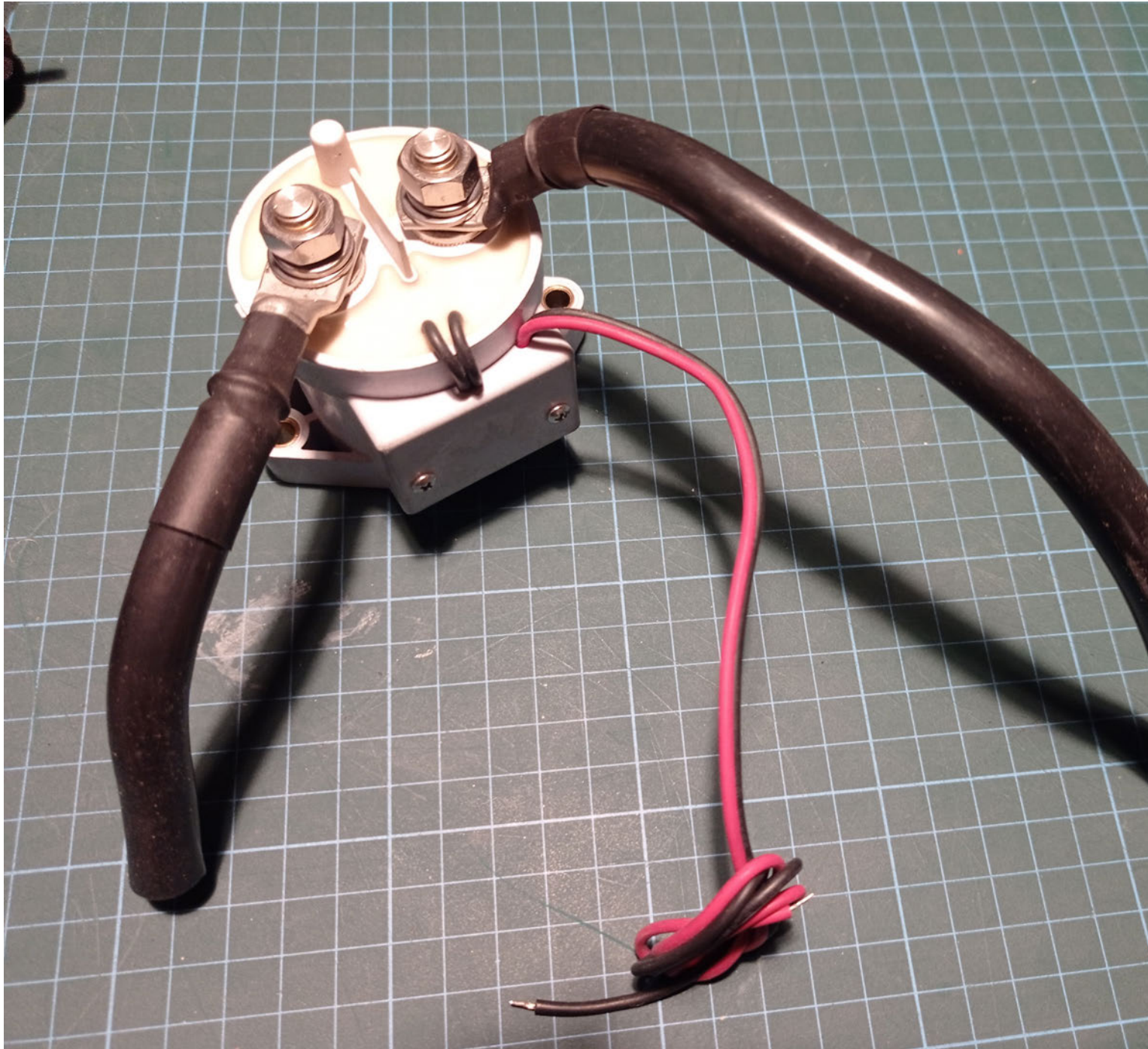

500+ Amp
12-900VDC
contactor

KILOVAC EV200 Series (CZONKA® Relay, Type III) (Continued)

Outline Dimensions

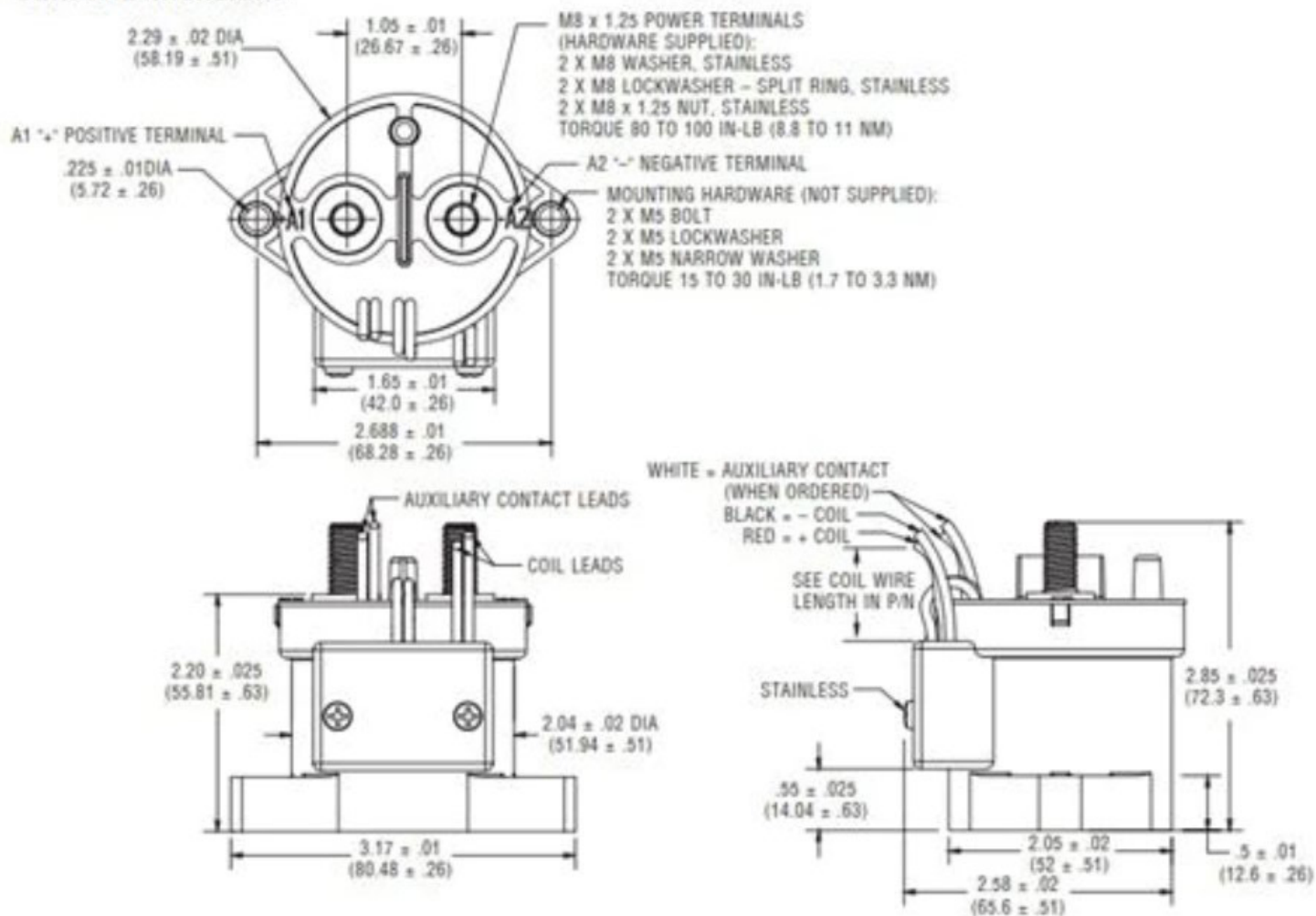

500+ Amp
12-900VDC
contactor

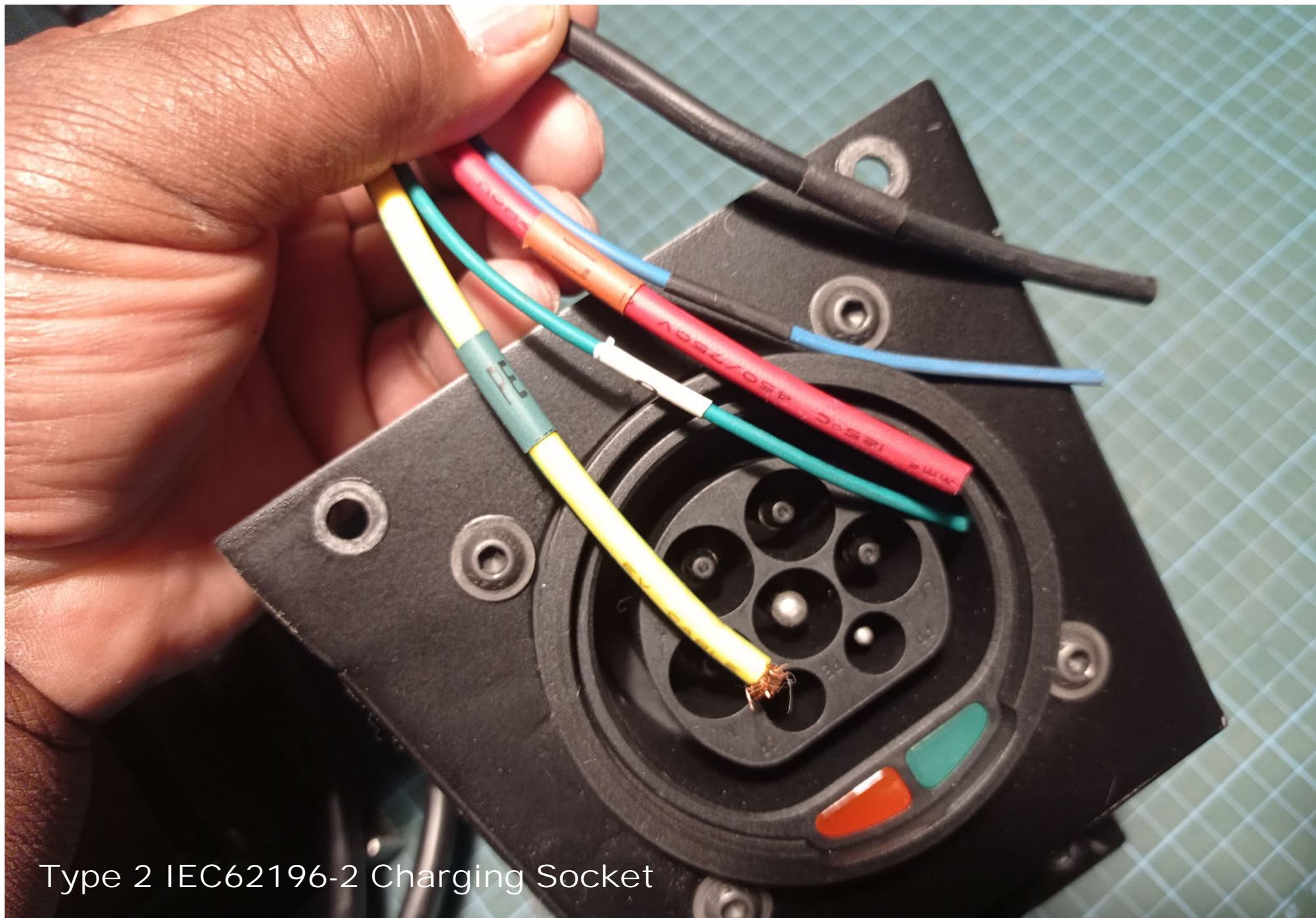

Type 2 IEC62196-2 Charging Socket

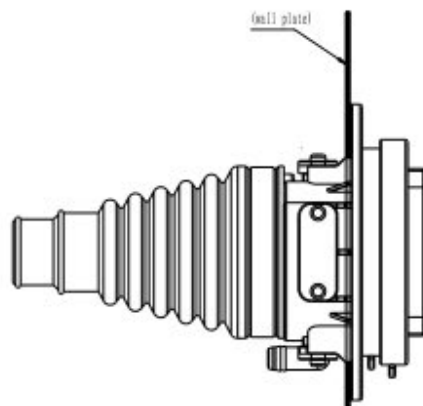
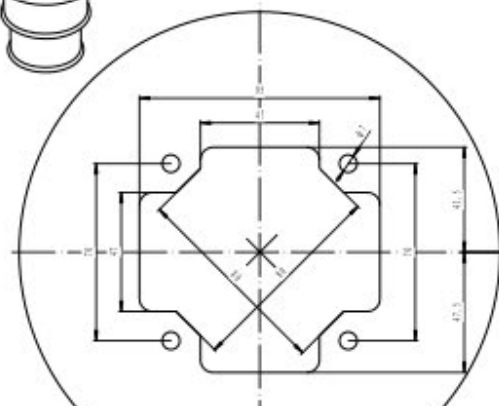
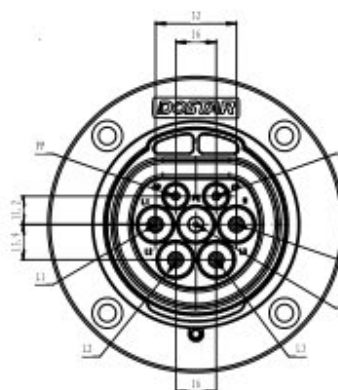
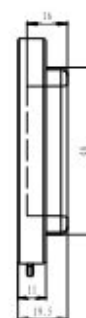
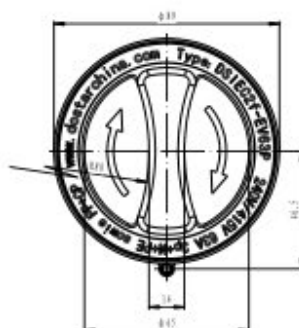
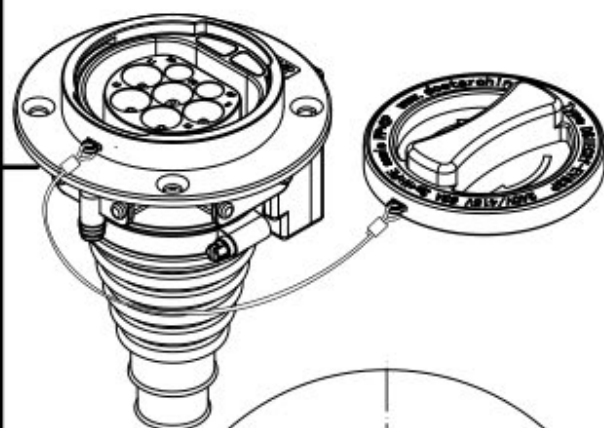
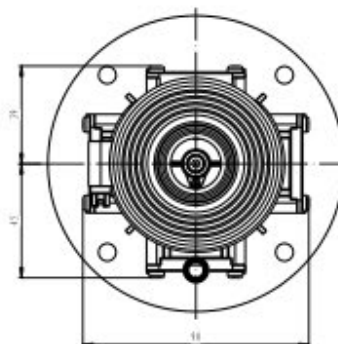
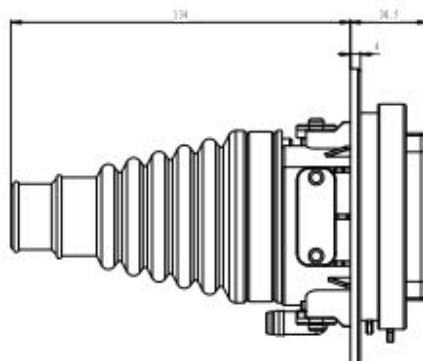
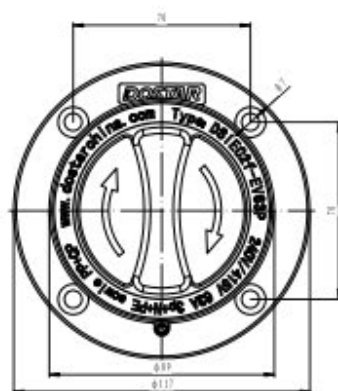

Technical parameters

Current and Voltage : 16A 240V AC

Signal current : 2A <30V DV

Protection Degree : IP54

Cable specification

Function	16A 240V AC
L1 (1)	2.5 mm ² Brown
L2 (2)	
L3 (3)	
N (4)	2.5 mm ² Blue
PE (5)	2.5 mm ² Olivine
CP (6)	0.5 mm ² Orange
PP (7)	0.5 mm ² White

PP (7)	
CP (6)	
PE (5)	
N (4)	
L3 (3)	
L2 (2)	
L1 (1)	

Charging cable 16A 1P+N+PE+PP+CP

The socket ,was designed according to the standard of 62196-2 IEC 2010 sheet 2-II f

Charging cable 2000mm 3*2.5mm²+2*0.5mm²

						Specifications			www.evcables.co.uk
标记	处数	分区	更改文件号	签名	年,月,日				EVSC004(32A)
设计			标准化			阶段	标记	重量	比例
审核									
工艺			批准			共	张	第	张
									1P+N+PE+PP+CP

Type 2 IEC62196-2 Charging Socket

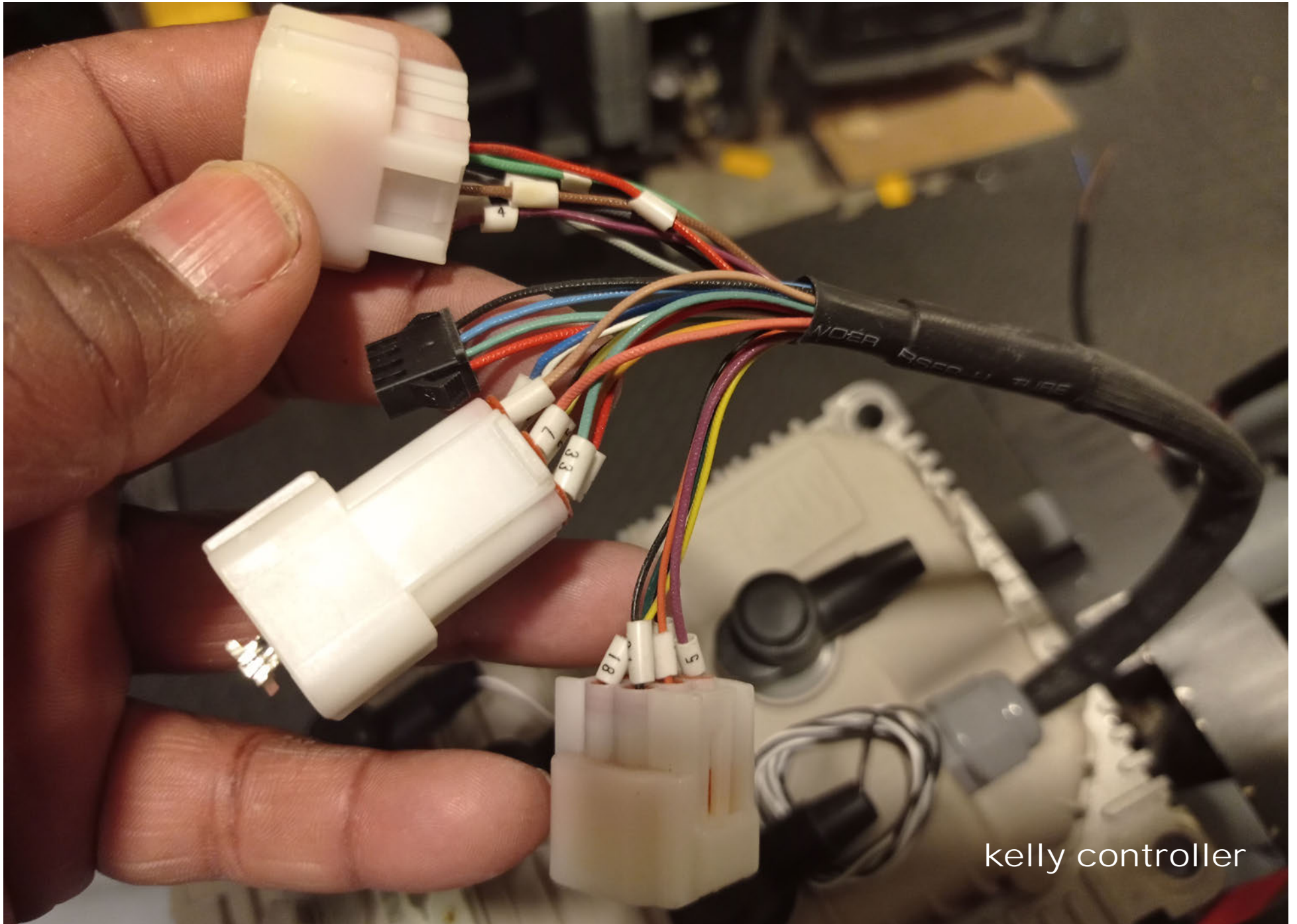

kelly controller

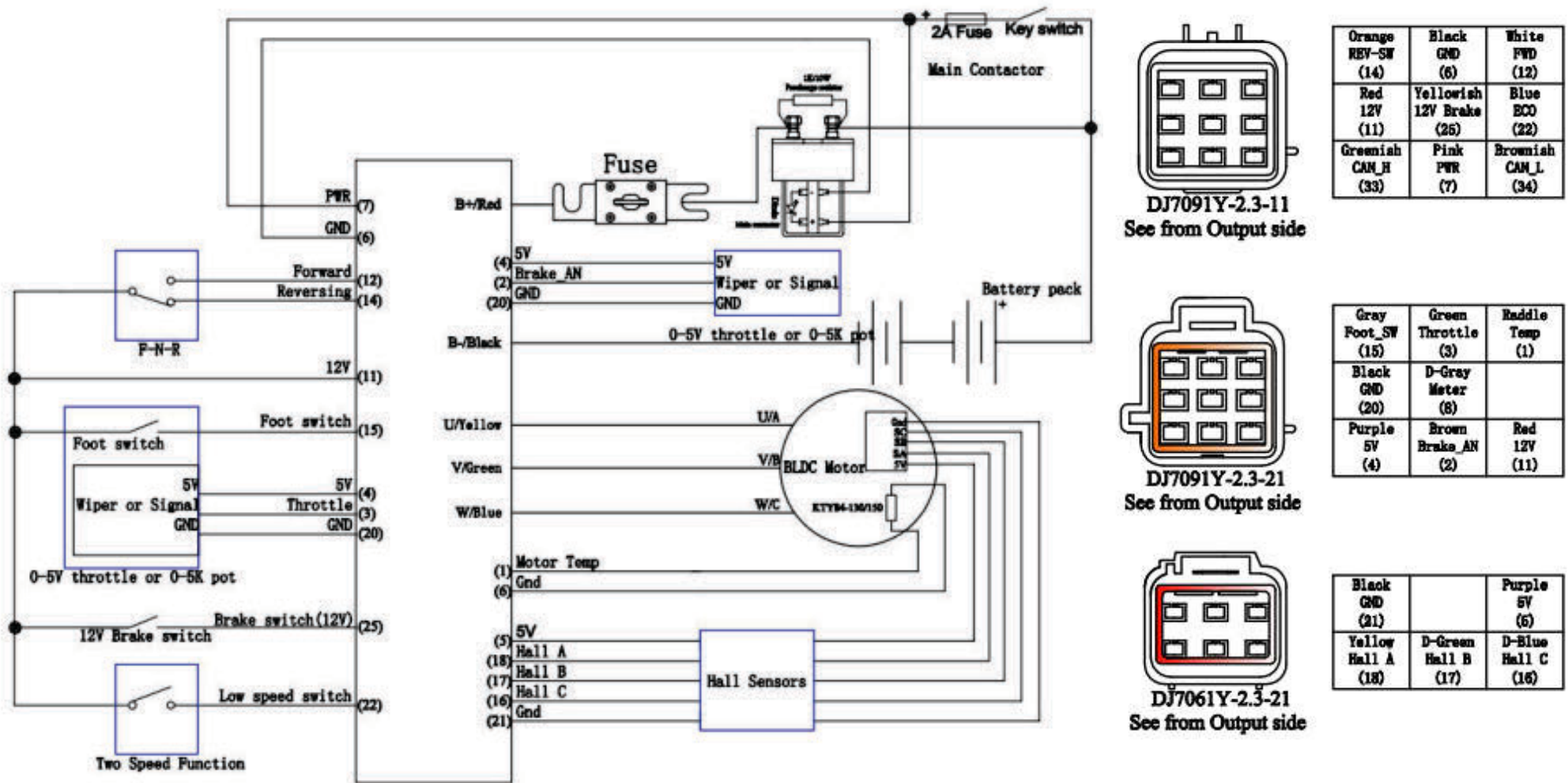

Figure 6: KLS-H controller standard wiring
(Battery voltage can be used for controller supply)

kelly controller

key ignition



key ignition

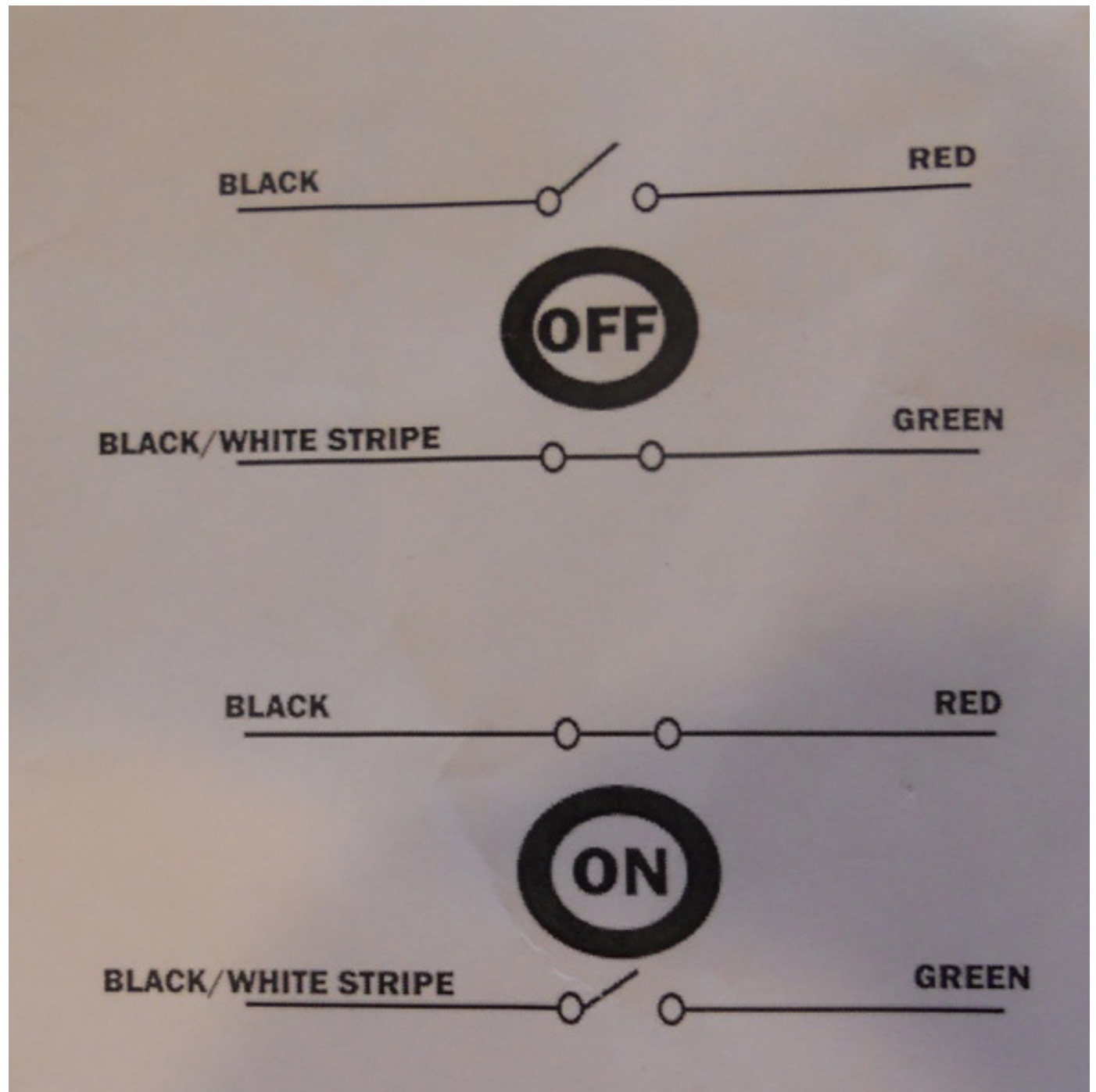

indicator flasher

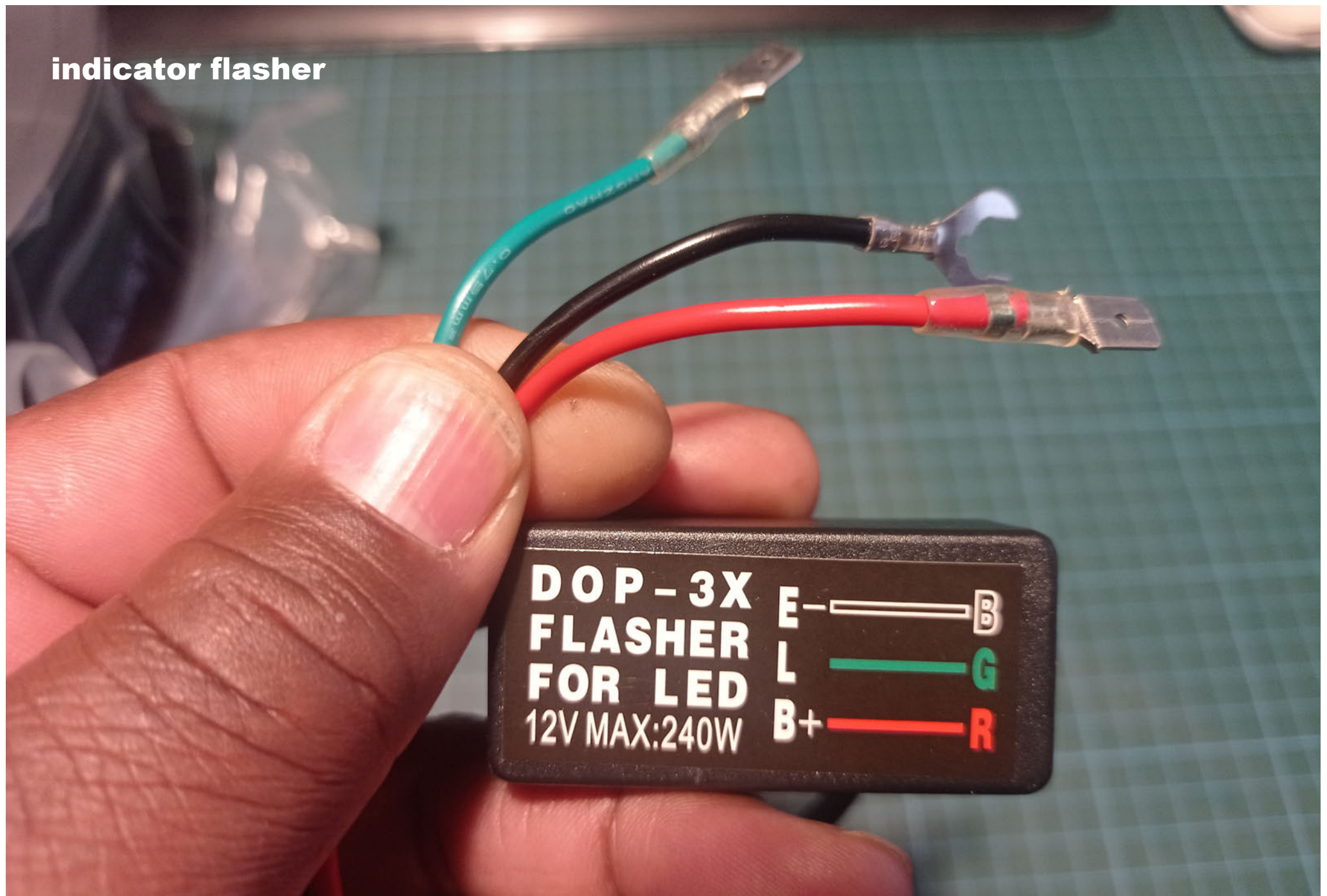

indicator flasher

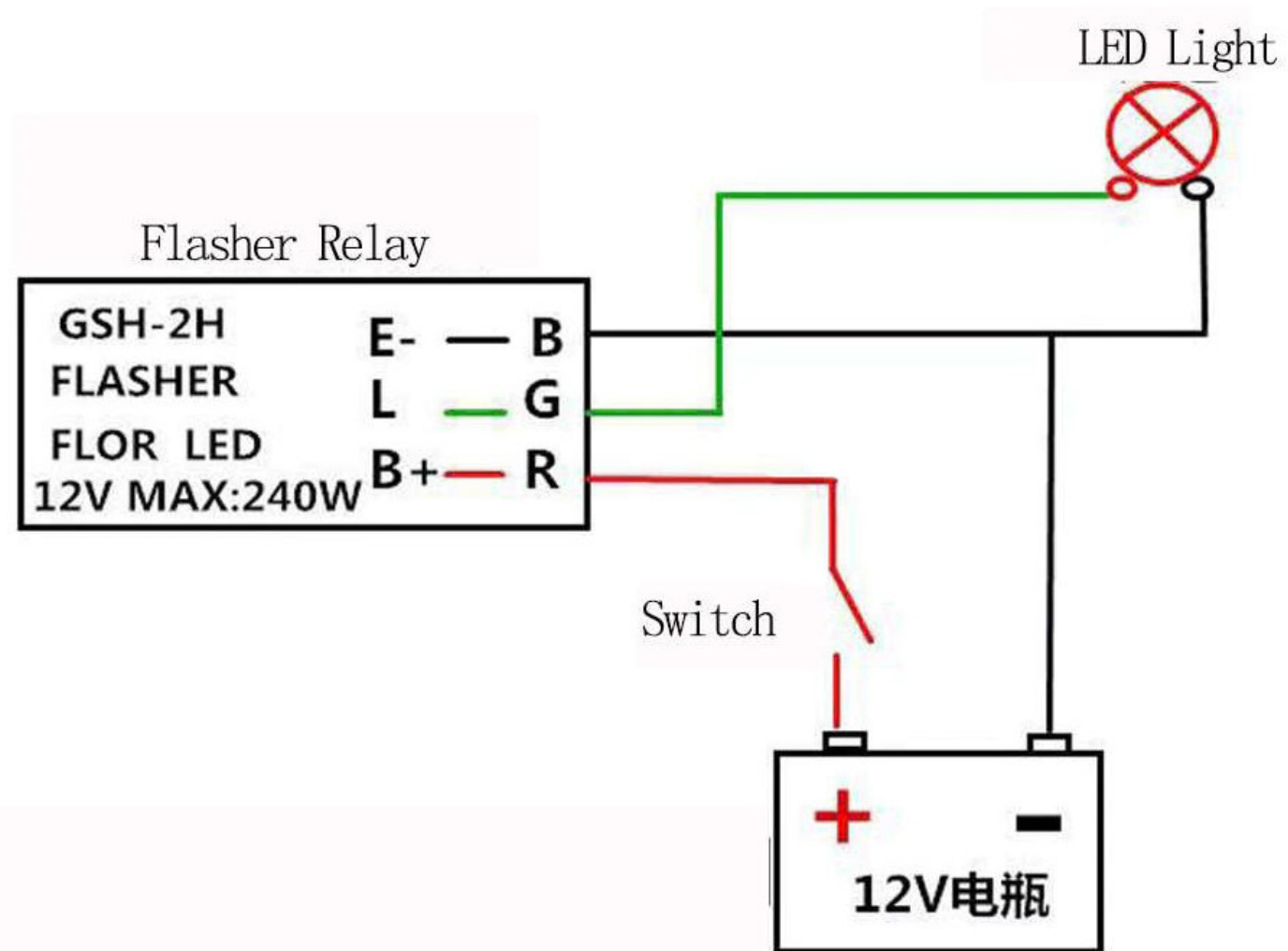

Endbar indicator

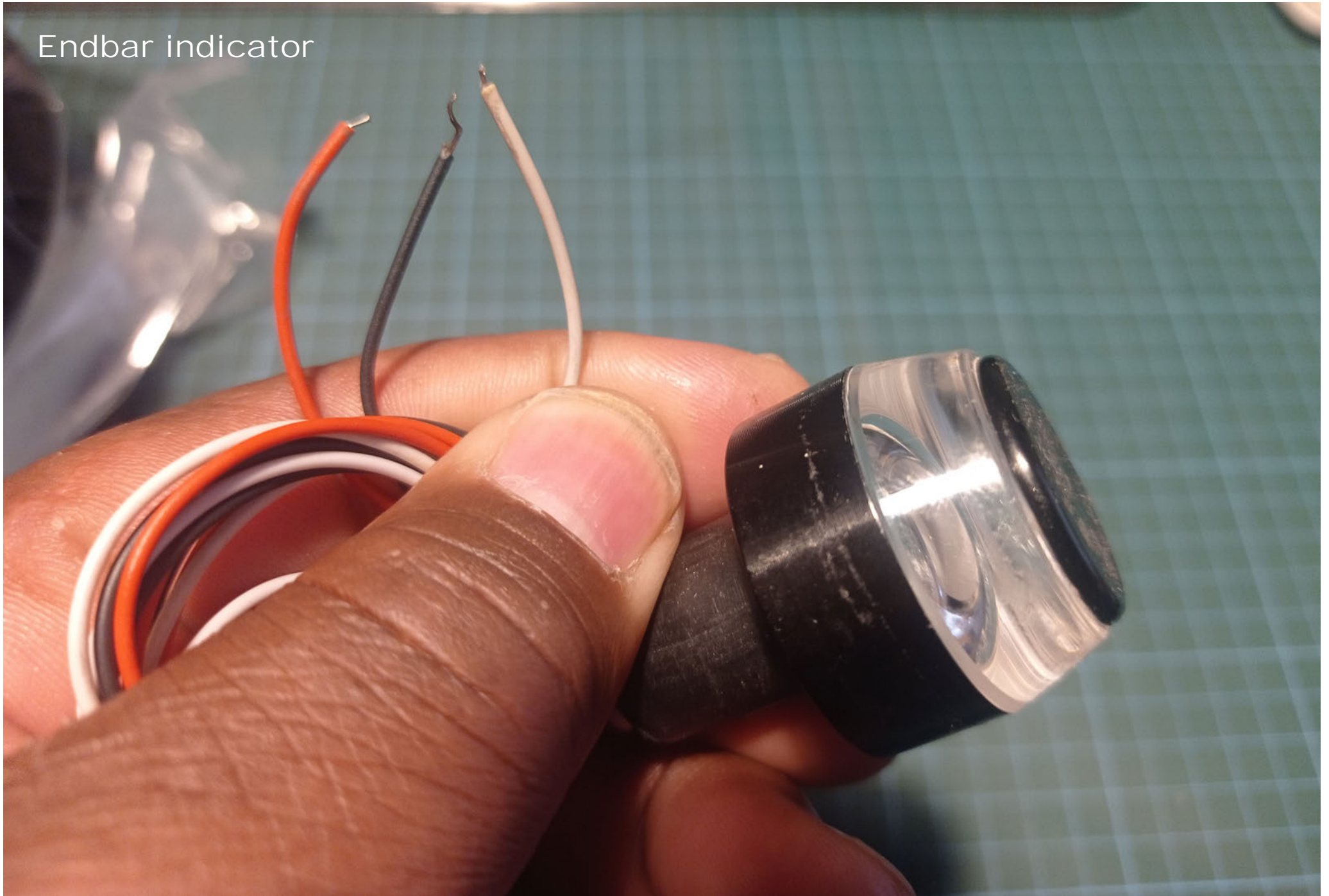

Endbar indicator

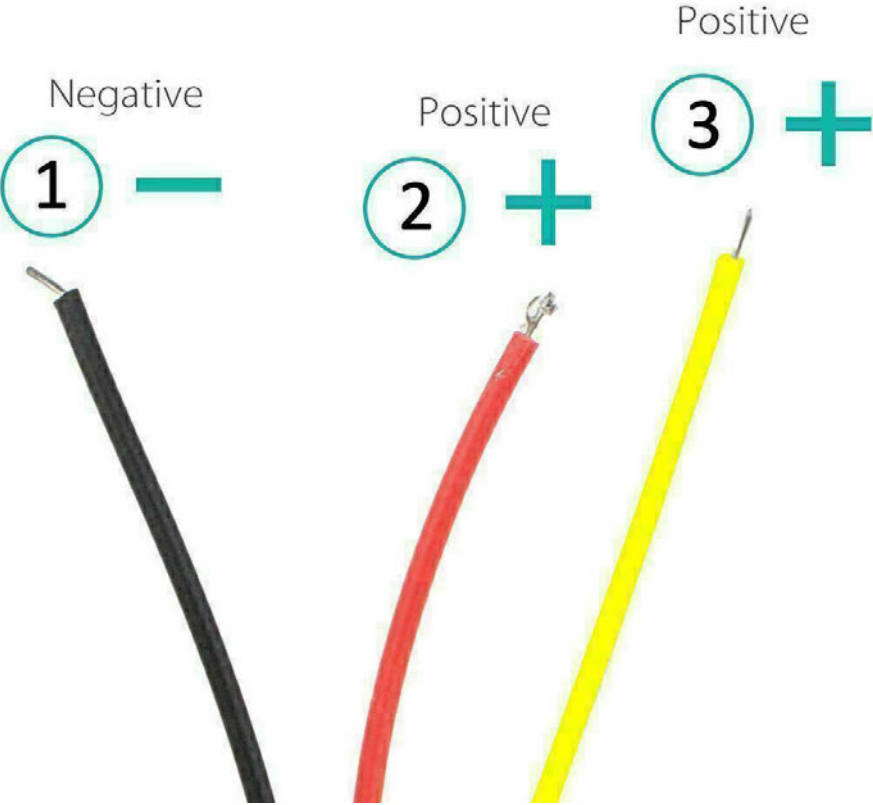
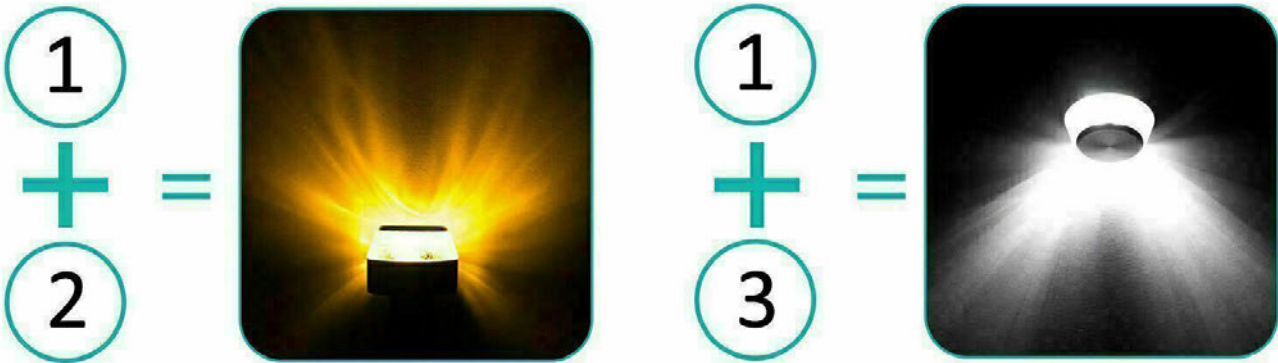



rear brake and indicator light



rear brake and indicator light



kickstand switch

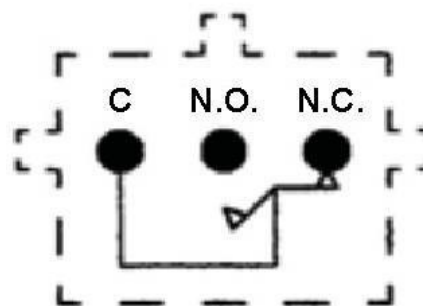

SWITCH POSITION	CONNECTION PIN-PIN
SET (BUTTON PRESSED AND RELEASED)	C - NC
FIRE	C - NO

inertia switch



48v - 12v DC-DC convertor

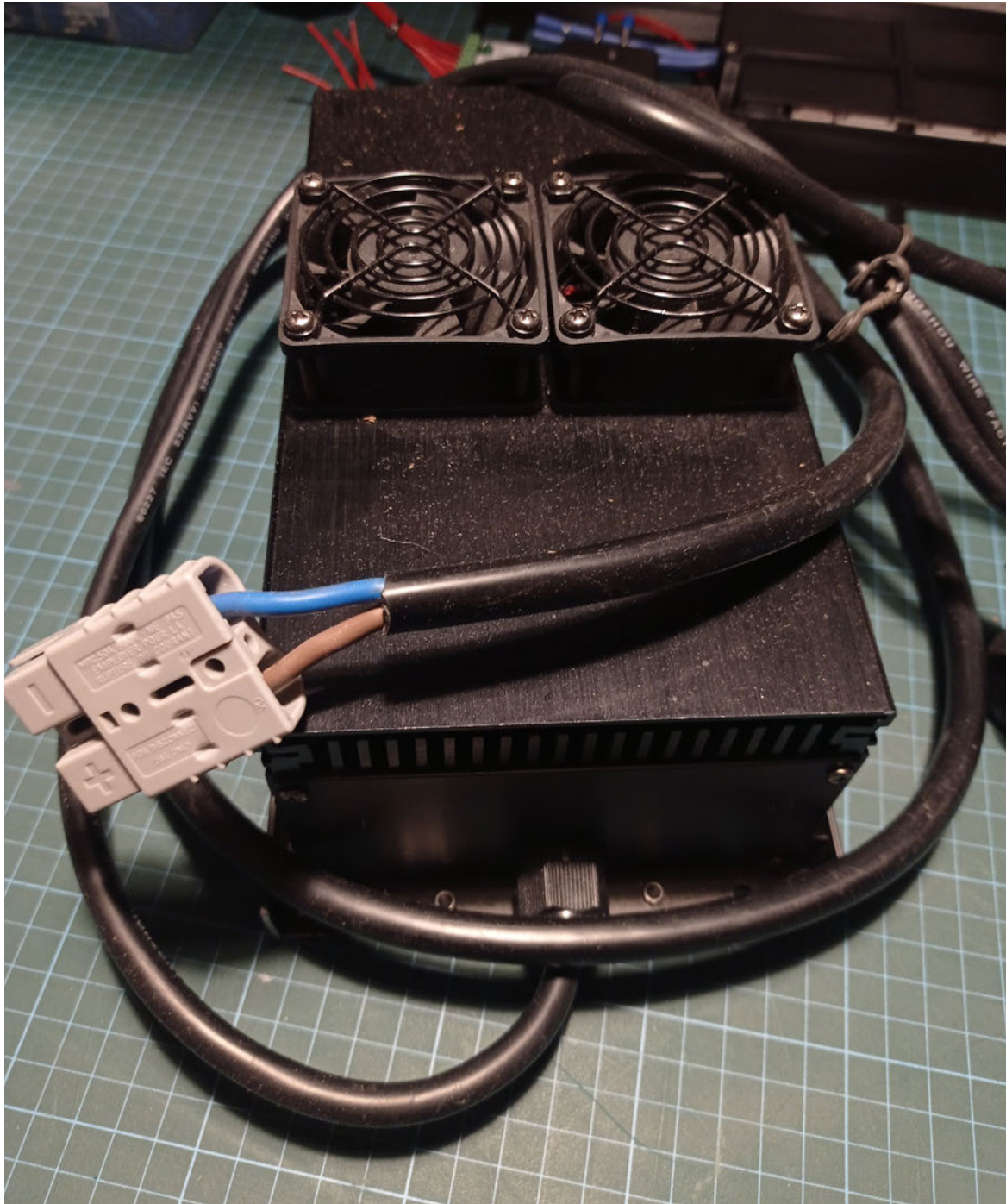

KP2000DR-60 Charger:
20A 48v with 2 sec
precharger

Manual: <https://xj600e.files.wordpress.com/2021/08/kp-1200dr-series-charger-manual.pdf>



kill switch



warning horn

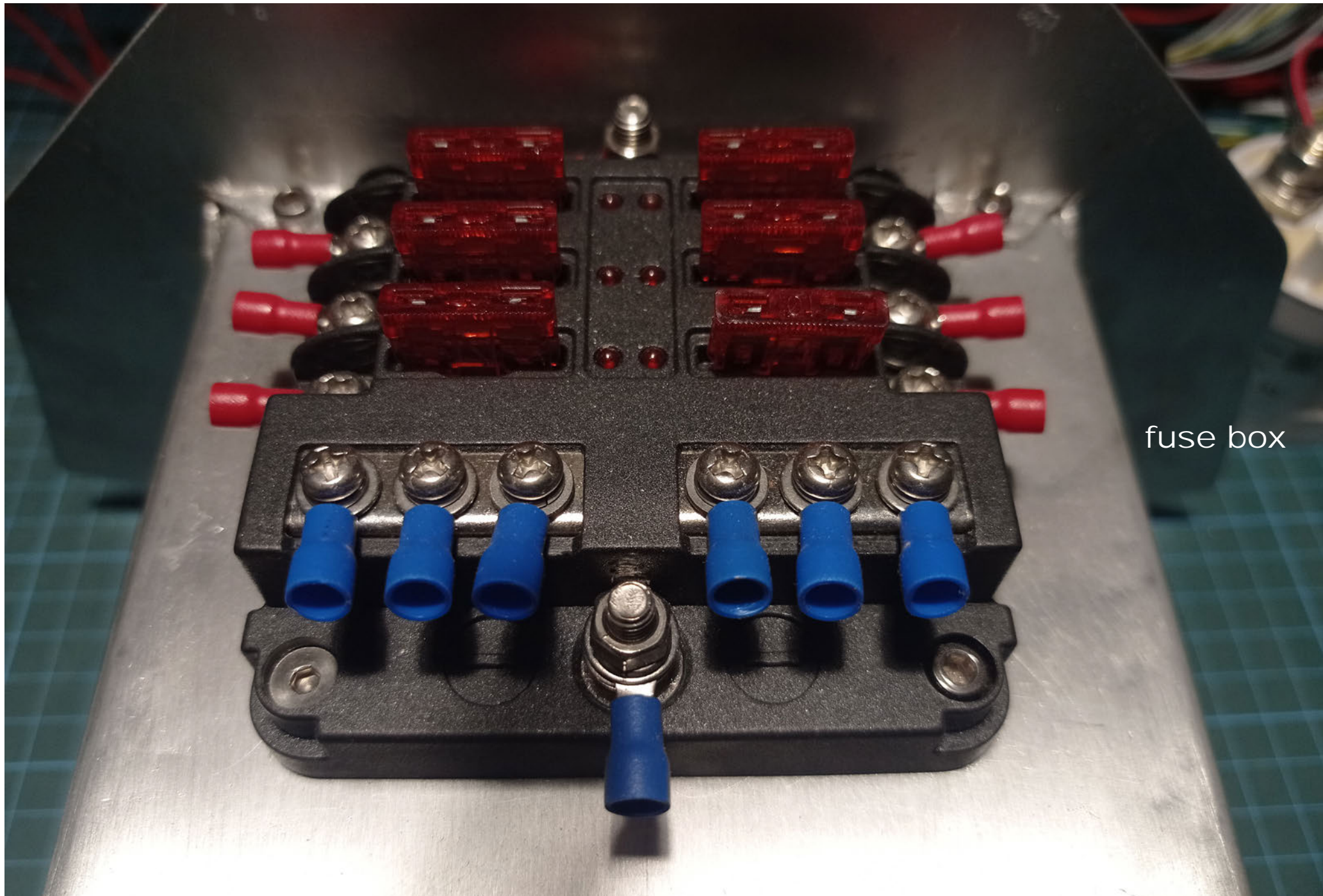

fuse box